

# Quik-Alloy Coupling Links

## How to Assemble:

1. Loop one half body through attachment, the other through chain. Fit together.
2. Place stud assembly and alloy locking pin in link.
3. Drive the locking pin in until the snap ring engages the recessed portion of the pin. (Link is disassembled by simply driving locking pin out.)

4. Per ASME B30.9, Section 9.1.3. "Mechanical coupling links shall not be used within the body of an alloy chain sling to connect two pieces of chain."

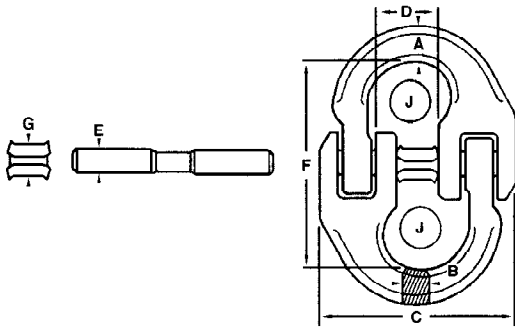
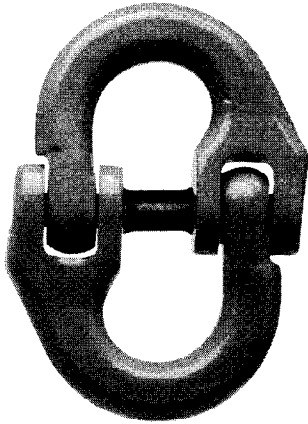

Chain Size	In.	mm	System	Cat. No.	UPC No. 020418	Approx. Weight Each		Working Load Limit	
						lb	kg	lb	kg
7/32	5.5	8	5770315	079993	.10	.05	2,100	970	
9/32	7	10	5779125	182754	.27	.13	4,300	1,950	
3/8	10	10	5779135	182761	.55	.25	8,800	4,000	
1/2	13	10	5779145	182860	1.65	.75	15,000	6,800	
5/8	16	10	5779155	182778	2.70	1.23	22,600	10,300	
3/4*	19	10	5779165	182785	4.30	1.95	35,300	16,000	
7/8*	22	10	5779175	080050	4.35	1.97	42,700	19,400	
1	26	8	5771615	080067	8.43	3.82	47,700	21,600	
1 1/4	32	8	5772015	080074	15.74	7.14	72,300	32,800	
Pins and Retainers									
9/32	7	10	5784425	182792	.02	.009	-	-	
3/8	10	10	5784435	182808	.06	.027	-	-	
1/2	13	10	5784445	182815	.11	.050	-	-	
5/8	16	10	5784455	182822	.17	.077	-	-	
3/4*	19	10	5784465	182839	.35	.159	-	-	
7/8*	22	10	5784165	181740	-	-	-	-	

Chain Size	Dimensions														Max. mat. Dia.		
	In.	mm	A	B	C	D	E	F	G	In.	mm	In.	mm	In.	mm	In.	mm
7/32	5.5	17/64	7	7/32	6	15/16	33	7/16	11	5/32	4	1 17/32	39	3/8	10	1/2	13
9/32	7	3/8	10	11/32	9	23/32	44	9/16	14	13/64	5	1 3/8	60	3/8	10	37/64	15
3/8	10	1/2	13	7/16	11	2 3/8	60	13/16	21	5/16	8	2 7/16	62	23/64	9	1 3/16	21
1/2	13	11/16	17	9/16	14	3	76	1 1/32	26	25/64	10	3 3/8	86	29/64	12	1 3/16	30
5/8	16	13/16	21	23/32	18	3 7/8	98	1 1/32	33	15/32	12	3 29/32	99	35/64	14	1 5/16	33
3/4	20	15/16	24	61/64	24	4 5/8	117	1 9/16	40	9/16	14	4 1/4	121	*	16	1 11/16	43
7/8	22	1 3/16	30	1 1/16	24	5 3/8	137	1 13/16	46	41/64	16	5 5/16	135	*	30	1 7/8	48
1	26	1 15/64	31	1 9/64	29	5 7/8	149	2 1/32	52	11/16	17	5 7/8	149	1 3/8	35	2 1/8	54
1 1/4	32	1 1/2	38	1 3/8	35	7 3/8	187	2 9/32	58	15/16	24	6 15/16	176	1 5/8	41	2 11/32	60

Dimensions and weights are approximate.

\* 3/4 and 7/8 use special oversize retainers.

Para prevenir la posibilidad de una lesión personal seria:  
 • **NO EXCEDA** los límites de carga de las cadenas o componentes.  
 • **NO LA UTILICE** si la cadena o los componentes están visualmente distorsionados o gastados.

To prevent the possibility of serious bodily injury:  
 • **DO NOT EXCEED** the working load limits for chain or components.  
 • **DO NOT USE** if the chain or components are visibly distorted or worn.

Slings